



Transport systems

Trolley 55.2-2

099-008630-EW501

Observe additional system documents!

20.03.2012

**Register now!**  
For your benefit  
**Jetzt Registrieren**  
und Profitieren!

[www.ewm-group.com](http://www.ewm-group.com)



# General instructions

## CAUTION



### Read the operating instructions!

The operating instructions provide an introduction to the safe use of the products.

- Read the operating instructions for all system components!
- Observe accident prevention regulations!
- Observe all local regulations!
- Confirm with a signature where appropriate.

## NOTE



**In the event of queries on installation, commissioning, operation or special conditions at the installation site, or on usage, please contact your sales partner or our customer service department on +49 2680 181-0.**

**A list of authorised sales partners can be found at [www.ewm-group.com](http://www.ewm-group.com).**

Liability relating to the operation of this equipment is restricted solely to the function of the equipment. No other form of liability, regardless of type, shall be accepted. This exclusion of liability shall be deemed accepted by the user on commissioning the equipment.

The manufacturer is unable to monitor whether or not these instructions or the conditions and methods are observed during installation, operation, usage and maintenance of the equipment.

An incorrectly performed installation can result in material damage and injure persons as a result. For this reason, we do not accept any responsibility or liability for losses, damages or costs arising from incorrect installation, improper operation or incorrect usage and maintenance or any actions connected to this in any way.

# 1 Contents

<b>1</b>	<b>Contents</b>	<b>3</b>
<b>2</b>	<b>Safety instructions</b>	<b>4</b>
2.1	Notes on the use of these operating instructions	4
2.2	Explanation of icons	5
2.3	General	6
2.4	Transport and installation	7
<b>3</b>	<b>Intended use</b>	<b>8</b>
<b>4</b>	<b>Machine description – quick overview</b>	<b>9</b>
4.1	Trolley 55.2-2	9
<b>5</b>	<b>Design and function</b>	<b>10</b>
5.1	System overview	10
5.2	Assembly	12
5.3	Mounting the welding machine or welding machine with cooling module	15
5.4	Assembly of the options	17
5.4.1	ON TR Trolley 55.2-2	17
5.4.1.1	Setting up the wire feed unit	18
5.4.2	ON PS Trolley 55.2-2 drive 4L	20
5.4.2.1	Setting up the wire feed unit	20
5.4.3	ON PS Trolley 55.2-2 drive 200/300C	21
5.4.3.1	Mount wire feeder on to pivot support	22
5.5	Intermediate hose package strain relief	23
5.6	Final assembly	24
5.7	Fixing and securing shielding gas cylinders	25
<b>6</b>	<b>Maintenance, care and disposal</b>	<b>26</b>
6.1	General	26
6.2	Maintenance work, intervals	26
6.2.1	Daily maintenance tasks	26
6.2.2	Monthly maintenance tasks	26
6.3	Maintenance work	26
6.4	Disposing of equipment	26
6.4.1	Manufacturer's declaration to the end user	27
6.5	Meeting the requirements of RoHS	27
<b>7</b>	<b>Technical data</b>	<b>28</b>
7.1	Trolley 55.2-2	28
7.1.1	ON TR Trolley 55.2-2	28
7.1.2	ON PS Trolley 55.2-2 drive 4L	28
7.1.3	ON PS Trolley 55.2-2 drive 200/300C	28
<b>8</b>	<b>Appendix A</b>	<b>29</b>
8.1	Overview of EWM branches	29

## 2 Safety instructions

### 2.1 Notes on the use of these operating instructions



#### **DANGER**

**Working or operating procedures which must be closely observed to prevent imminent serious and even fatal injuries.**

- Safety notes include the "DANGER" keyword in the heading with a general warning symbol.
- The hazard is also highlighted using a symbol on the edge of the page.



#### **WARNING**

**Working or operating procedures which must be closely observed to prevent serious and even fatal injuries.**

- Safety notes include the "WARNING" keyword in the heading with a general warning symbol.
- The hazard is also highlighted using a symbol in the page margin.



#### **CAUTION**

**Working or operating procedures which must be closely observed to prevent possible minor personal injury.**

- The safety information includes the "CAUTION" keyword in its heading with a general warning symbol.
- The risk is explained using a symbol on the edge of the page.

#### **CAUTION**

**Working and operating procedures which must be followed precisely to avoid damaging or destroying the product.**

- The safety information includes the "CAUTION" keyword in its heading without a general warning symbol.
- The hazard is explained using a symbol at the edge of the page.

#### **NOTE**











**Special technical points which users must observe.**

- Notes include the "NOTE" keyword in the heading without a general warning symbol.

Instructions and lists detailing step-by-step actions for given situations can be recognised via bullet points, e.g.:

- Insert the welding current lead socket into the relevant socket and lock.

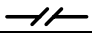
## 2.2 Explanation of icons

Symbol	Description
	Press
	Do not press
	Turn
	Switch
	Switch off machine
	Switch on machine
	ENTER (enter the menu)
	NAVIGATION (Navigating in the menu)
	EXIT (Exit the menu)
	Time display (example: wait 4s/press)
	Interruption in the menu display (other setting options possible)
	Tool not required/do not use
	Tool required/use

## 2.3 General

### **DANGER**



- Do not carry out any unauthorised repairs or modifications!**  
**To avoid injury and equipment damage, the unit must only be repaired or modified by specialist, skilled persons!**  
**The warranty becomes null and void in the event of unauthorised interference.**
- Appoint only skilled persons for repair work (trained service personnel)!

### **WARNING**



- Risk of accidents if these safety instructions are not observed!**  
**Non-observance of these safety instructions is potentially fatal!**
- Carefully read the safety information in this manual!
  - Observe the accident prevention regulations in your country.
  - Inform persons in the working area that they must observe the regulations!



- Validity of this document!**  
**This document is only valid in combination with the operating instructions for the power source being used (welding machine)!**
- Read the operating instructions, in particular the safety instructions for the power source (welding machine)!

### **CAUTION**



- Obligations of the operator!**  
**The respective national directives and laws must be observed for operation of the machine!**
- National implementation of the framework directive (89/391/EEG), as well as the associated individual directives.
  - In particular, directive (89/655/EEG), on the minimum regulations for safety and health protection when staff members use equipment during work.
  - The regulations regarding work safety and accident prevention for the respective country.
  - Setting up and operating the machine according to IEC 60974-9.
  - Check at regular intervals that users are working in a safety-conscious way.
  - Regular checks of the machine according to IEC 60974-4.

## 2.4 Transport and installation

### ⚠ WARNING



#### Improper work carried out!

In the event of improper work carried out on the display stand, the display stand may lose stability, tip over and result in serious injury!

- Only use the construction and fitting parts supplied!
- Do not load the display stand without reinforcement panels affixed!



#### Risk of accident due to improper transport of machines that may not be lifted!

Do not lift or suspend the machine! The machine can fall down and cause injuries! The handles and brackets are suitable for transport by hand only!

- The machine may not be lifted by crane or suspended!

### ⚠ CAUTION



#### Improperly secured equipment!

Equipment, equipment combinations and accessories incorrectly fastened onto transport systems can tip over during transport and cause injuries!

- Only used the original parts supplied to fasten the equipment.
- Use the systems only for transporting the machines given in the "Intended use" chapter.
- Check the fixing points before each transport and at regular intervals.



#### Damage due to supply lines not being disconnected!

During transport, supply lines which have not been disconnected (mains supply leads, control leads, etc.) may cause hazards such as connected equipment tipping over and injuring persons!

- Disconnect supply lines!



#### Risk of tipping!

When moving or setting up, the transport vehicle can tip over and injure persons or become damaged.

- Move or set up the machine on level, firm surfaces.
- Secure add-on parts using suitable equipment.
- Replace damaged transport rollers and their fixing elements.

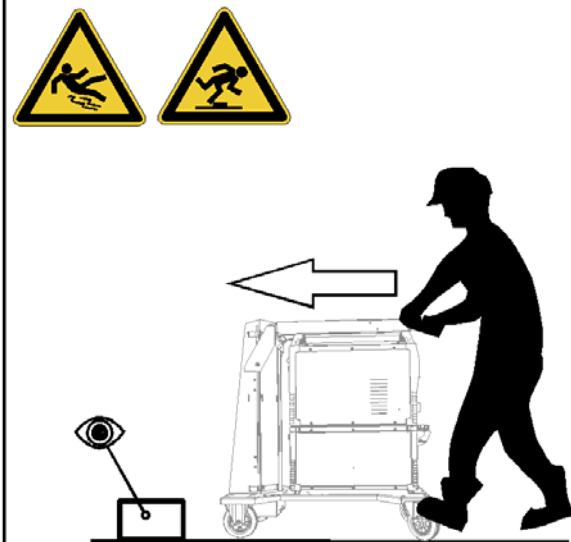
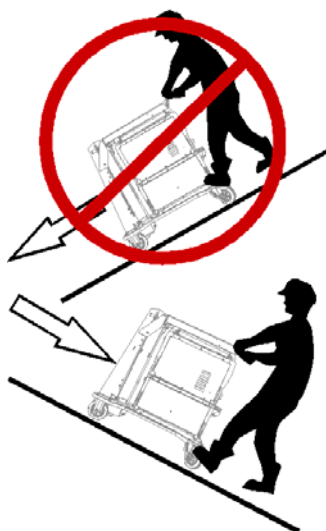

Figure 2-1

### 3 Intended use

#### **WARNING**



##### **Hazards due to improper usage!**

**Hazards may arise for persons, animals and material objects if the equipment is not used correctly. No liability is accepted for any damages arising from improper usage!**

- The equipment must only be used in line with proper usage and by trained or expert staff!
- Do not modify or convert the equipment improperly!

#### **CAUTION**



##### **Risk of accidents due to improperly prepared transport vehicle!**

**Depending on the machine series the transport vehicle has to be adapted to mount the machine. Failing to adapt the transport vehicle can cause the machine being transported to topple and lead to injuries!**

#### **NOTE**



**Additional options for holding a wire feeder have to be retrofitted to the trolley for MIG/MAG machines.**

- Refer to the system overview chapter!

The Trolley 55.2-2 transport system is suitable for:

- moving the machines and machine combinations listed,
- moving properly fixed machines and add-on parts that are suitably secured.

Any other use of the transport systems is regarded as "improper" and no liability is assumed for any damage arising therefrom.

#### **Power source**

- Phoenix 405, 505
- Taurus 405, 505

#### **Wire feed unit**

- drive 4
- drive 4L
- drive 200C
- drive 300C

#### **Cooling unit**

- cool50 U40
- cool50-2 U40



## 4 Machine description – quick overview

### 4.1 Trolley 55.2-2

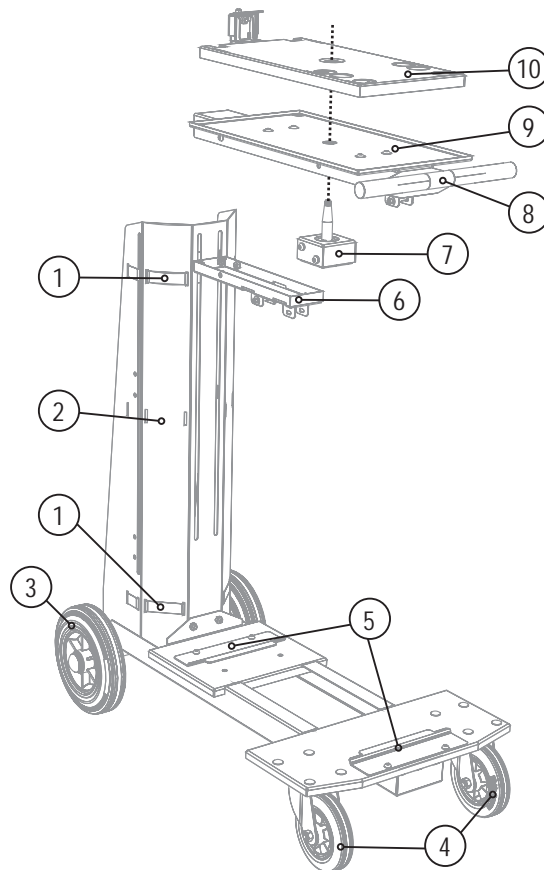

Figure 4-1

Item	Symbol	Description
1		<b>Straps</b>
2		<b>Retainer panel for gas cylinder</b>
3		<b>Wheels, fixed castors</b>
4		<b>Wheels, guide castors</b>
5		<b>Machine mounting attachment</b>
6		<b>Hold-down fitting for welding machine</b>
7		<b>ON PS Trolley 55.2-2 drive 4L</b> Pivot support
8		<b>Carrying handle</b>
9		<b>ON TR Trolley 55.2-2</b> Cross arm and holder for wire feeder
10		<b>ON PS Trolley 55.2-2 drive 200/300C</b> Pivot support

5 Design and function

5.1 System overview

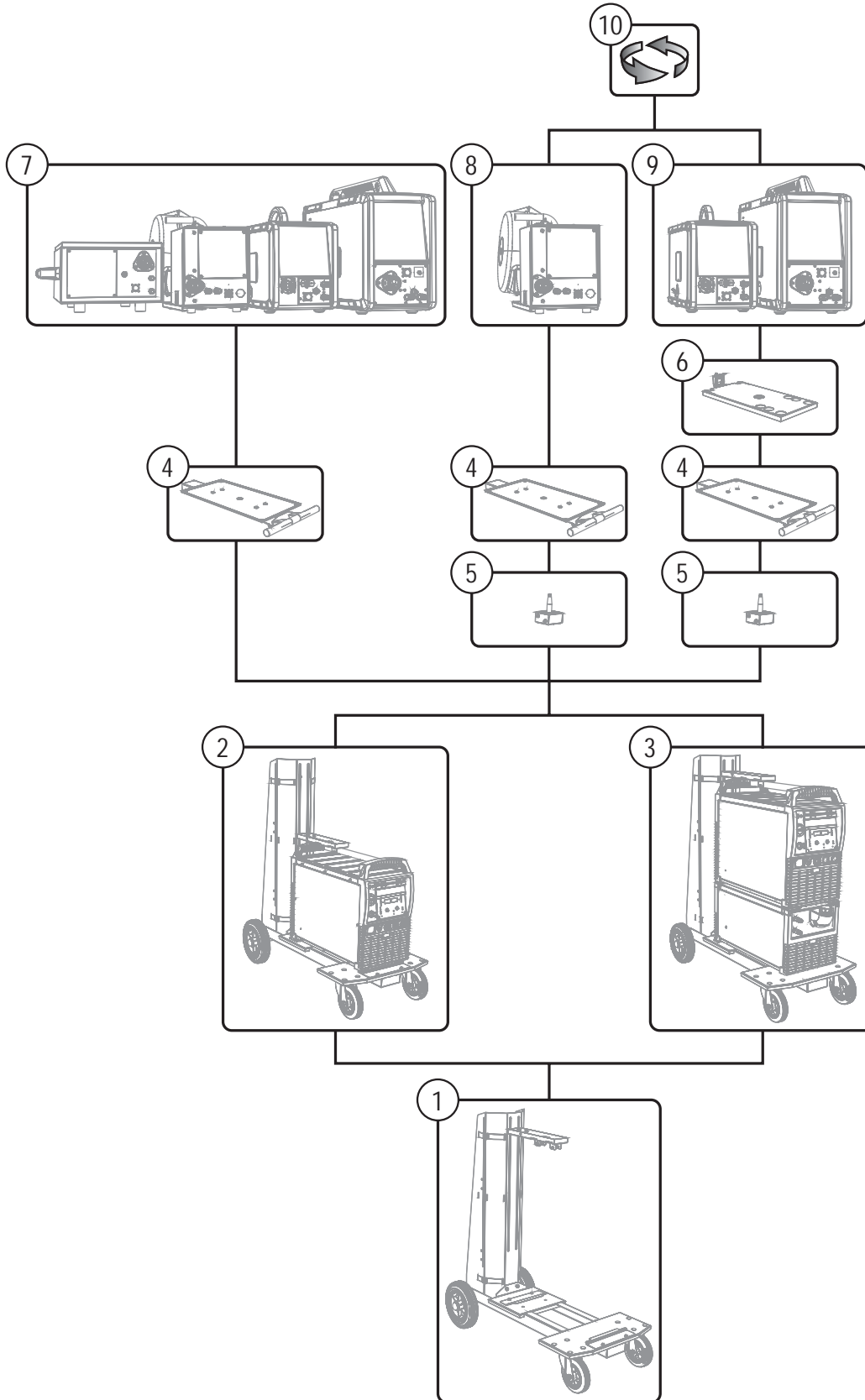

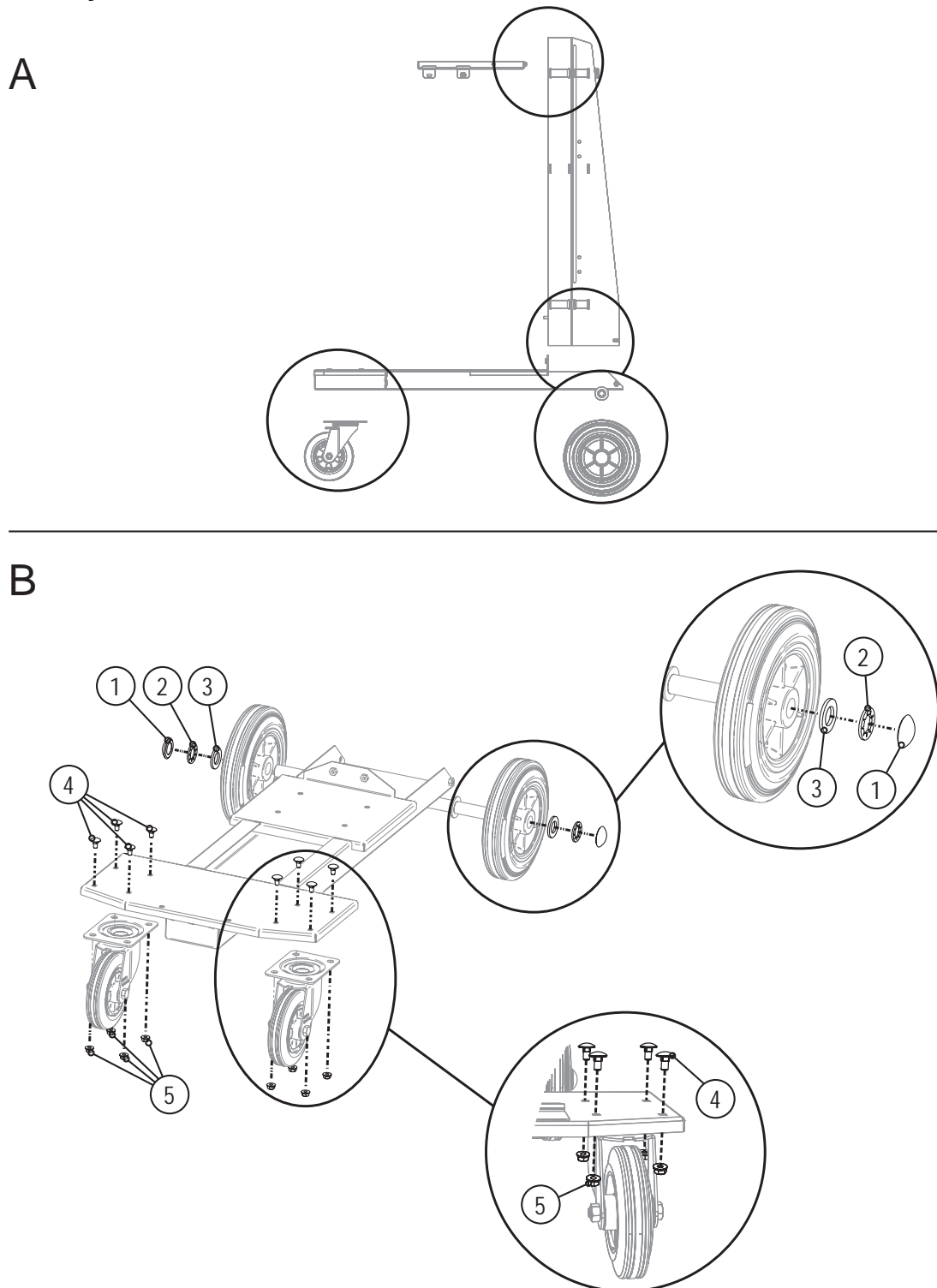

Figure 5-1

Item	Symbol	Description
1		Transport vehicle - Trolley 55.2-2
2		Transport vehicles - Trolley 55.2-2 + Power source 405 /505
3		Transport vehicles - Trolley 55.2-2 + Power source 405 /505 + cool
4		<b>ON TR Trolley 55.2-2</b> Cross arm and holder for wire feeder - 092-002700-00000
5		<b>ON PS Trolley 55.2-2 drive 4L</b> Pivot support – 092-002701-00000
6		<b>ON PS Trolley 55.2-2 drive 200/300C</b> Pivot support - 092-002634-00000
7		<b>All wire feeders - drive</b>
8		<b>Wire feeder - drive 4L (pivotable)</b>
9		<b>Wire feeders - drive 200/300C (pivotable)</b>
10		<b>Pivotable</b>

## 5.2 Assembly



C

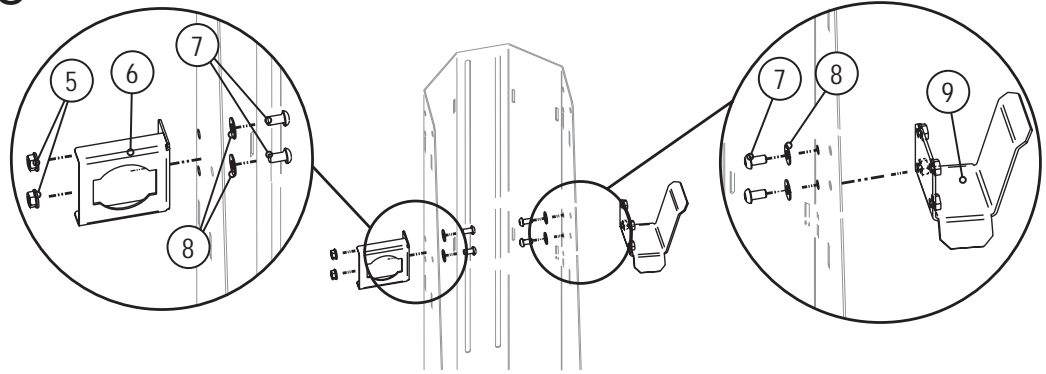

D

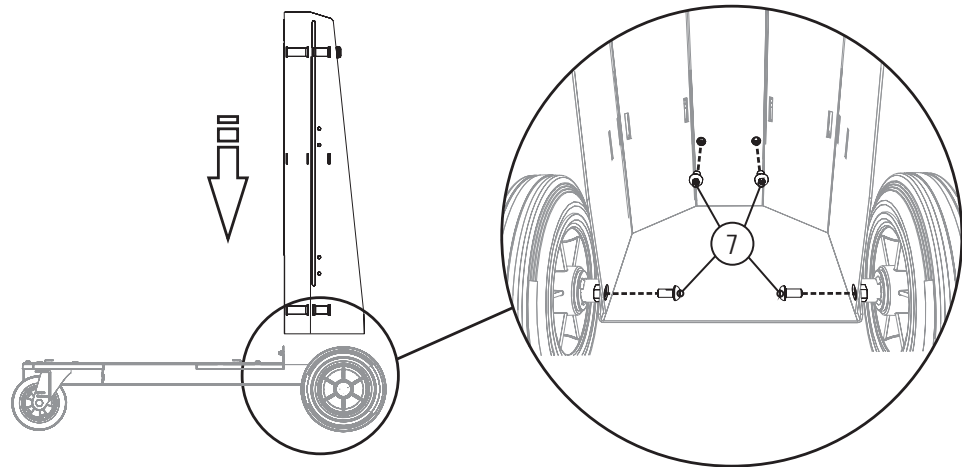

E

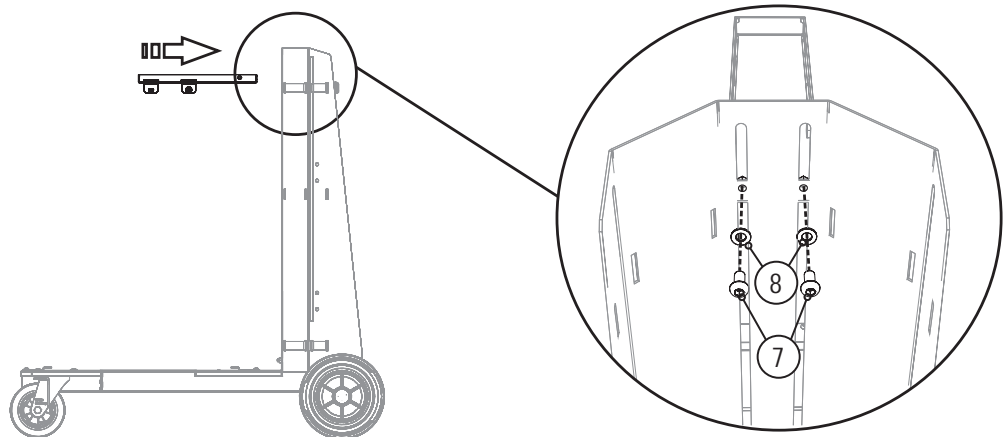

Figure 5-3

Item 0	Quantity	Description	Item number
1	2	Cap, wheel fastening	094-002321-00000
2	2	Safety washer 41.3x3.2	094-018120-00000
3	2	Washer, M24	094-014304-00000
4	8	M8x16, mushroom head bolt	094-001125-00000
5	10	M8, serrated nut	064-000560-00000
6	1	Intermediate hose package strain relief	094-008853-00002
7	4	M8 x 16 oval-head screw	094-007803-00000
8	2	Fender washer	064-000793-00000
9	1	Hose package holder	094-018362-00000

### 5.3 Mounting the welding machine or welding machine with cooling module

#### NOTE

The welding machines can be mounted on the transport vehicle with or without cooling unit. When mounting a machine without cooling unit, the machine hold-down device has to be mounted in a lower position, however.

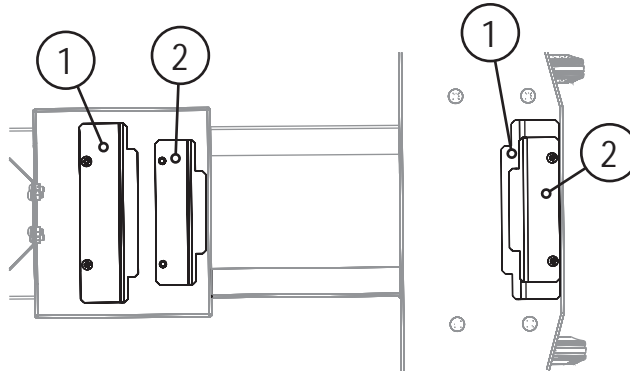

Figure 5-4

	1	2
<b>Phoenix 335, 405, 505</b>	<input checked="" type="checkbox"/>	<input type="checkbox"/>
<b>Taurus 335, 405, 505</b>	<input checked="" type="checkbox"/>	<input type="checkbox"/>
<b>Tetrix 230, 270</b>	<input type="checkbox"/>	<input checked="" type="checkbox"/>
<b>Picotig 190</b>	<input type="checkbox"/>	<input checked="" type="checkbox"/>

possible

not possible

A

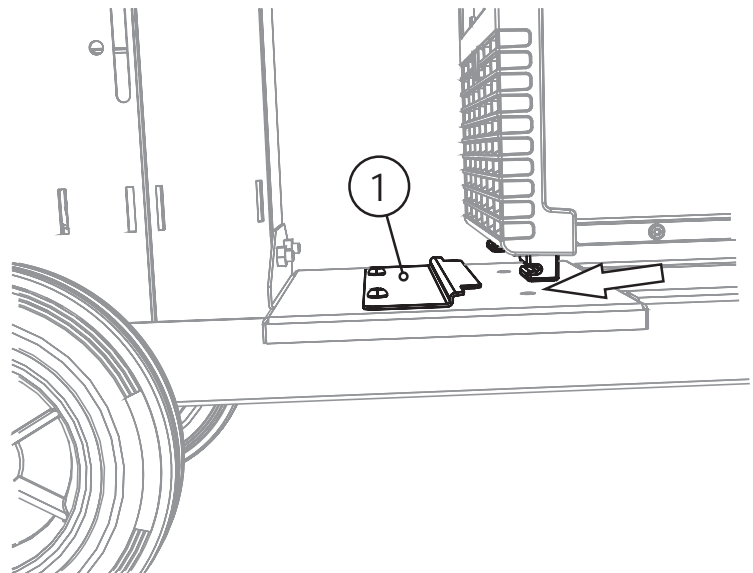
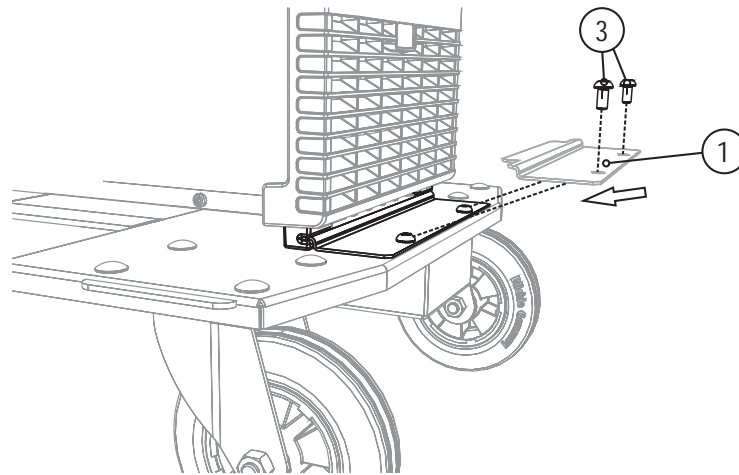

Figure 5-5

B



C

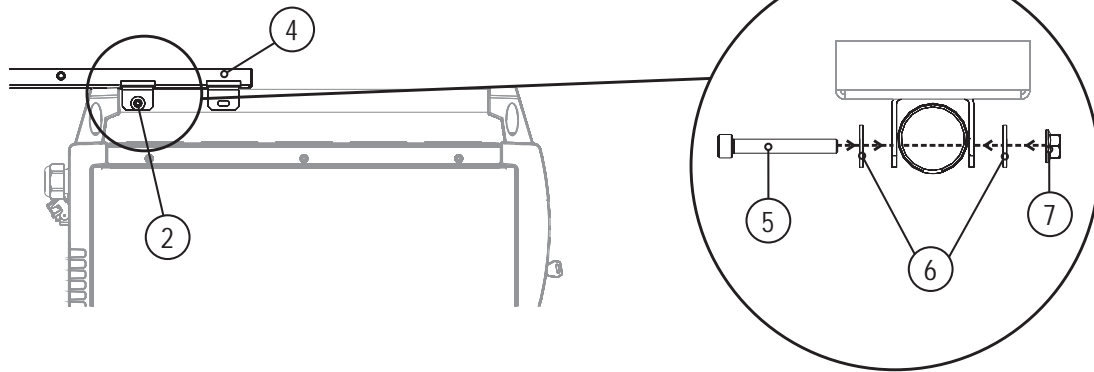

Figure 5-6

Item	Symbol	Description
1		Machine mounting attachment
2		Screw connection Cylinder head bolt + Fender washer + Hexagonal nut
3		Flat head screw
4		Hold-down fitting for welding machine
5		Cylinder head screw
6		Fender washer
7		Hexagon nut

- Place and fix the machine on the carrier plate. (figure A, B).
- Adjust the cross bar height to the machine height.
- Fix the machine to the grip bar using the screw. (figure C).



**5.4 Assembly of the options**

**5.4.1 ON TR Trolley 55.2-2**

A

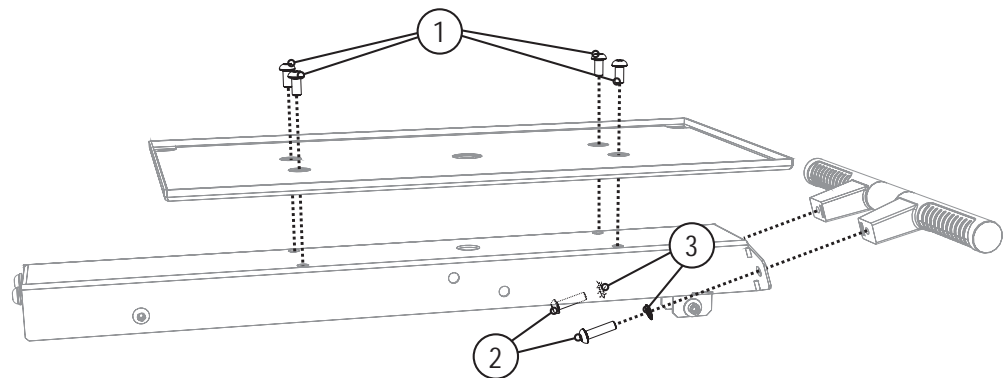

B

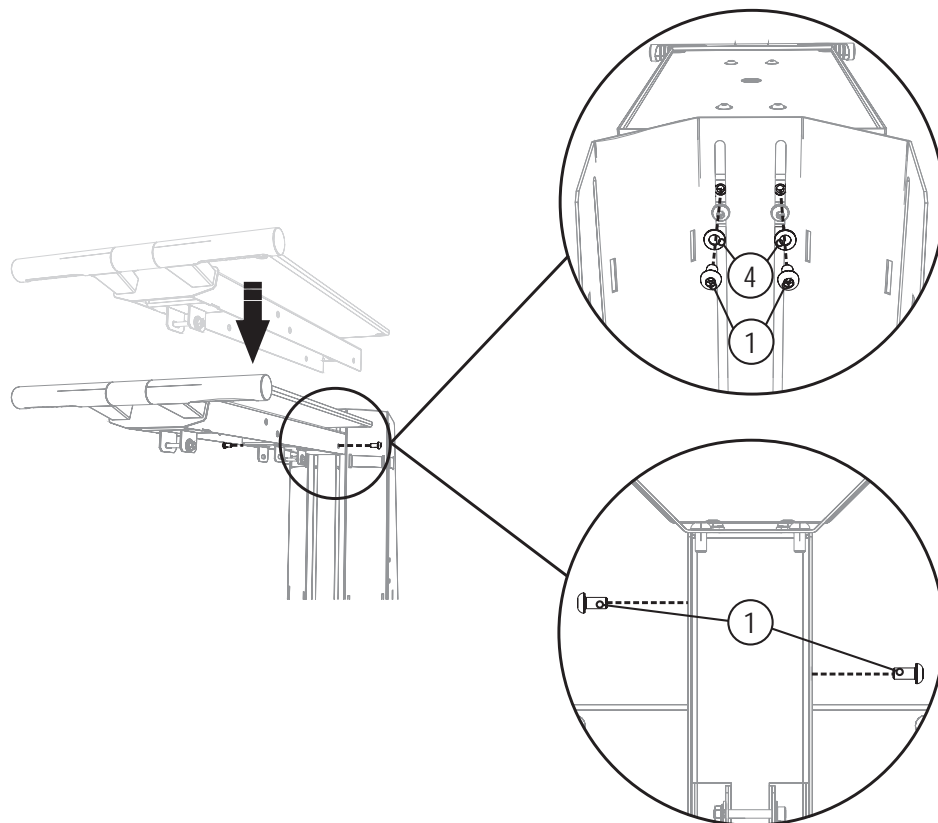

Figure 5-7

Item	Symbol	Description
1		Oval-head screw
2		M8x30 hexagonal screw
3		Internal tooth lock washer M8x30
4		Plain washer M8

## 5.4.1.1 Setting up the wire feed unit

### CAUTION



**Machines not placed properly!**

**Machines not placed in an upright position may tilt and cause injuries to persons!**

- The machine's feet must be in a stable position!

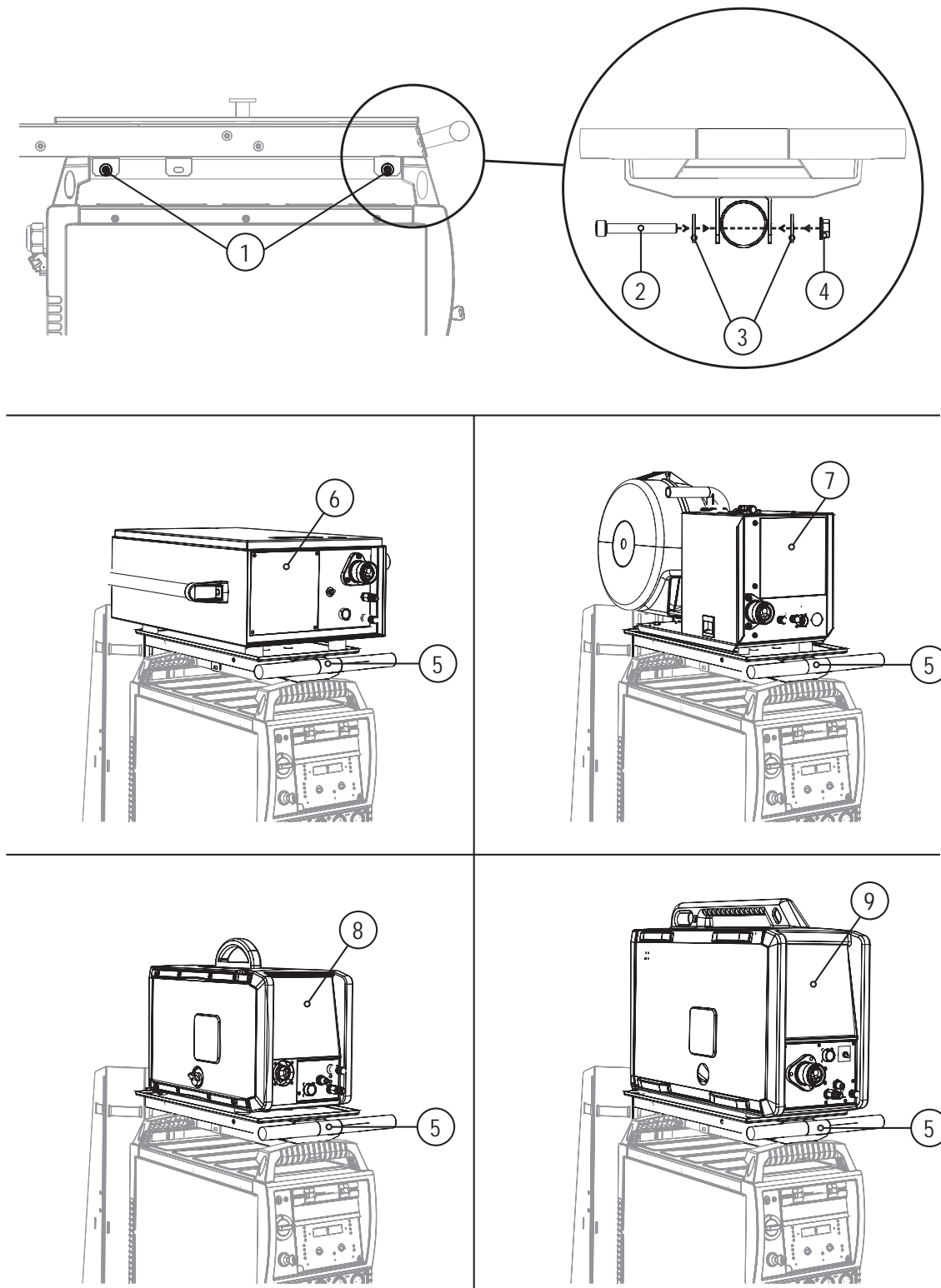

Figure 5-8

---

Item	Symbol	Description
1		<b>Screw connection</b> Cylinder head bolt + Fender washer + Hexagonal nut
2		<b>Cylinder head screw</b>
3		<b>Fender washer</b>
4		<b>Hexagon nut</b>
5		<b>ON TR Trolley 55.2-2</b> Cross arm and holder for wire feeder
6		<b>Wire feed unit - drive 4</b>
7		<b>Wire feed unit - drive 4L</b>
8		<b>Wire feed unit - drive 200C</b>
9		<b>Wire feed unit - drive 300C</b>

- Fix the machine to the grip bar using two screws.
- Set up the wire feeder according to the figures.

## 5.4.2 ON PS Trolley 55.2-2 drive 4L

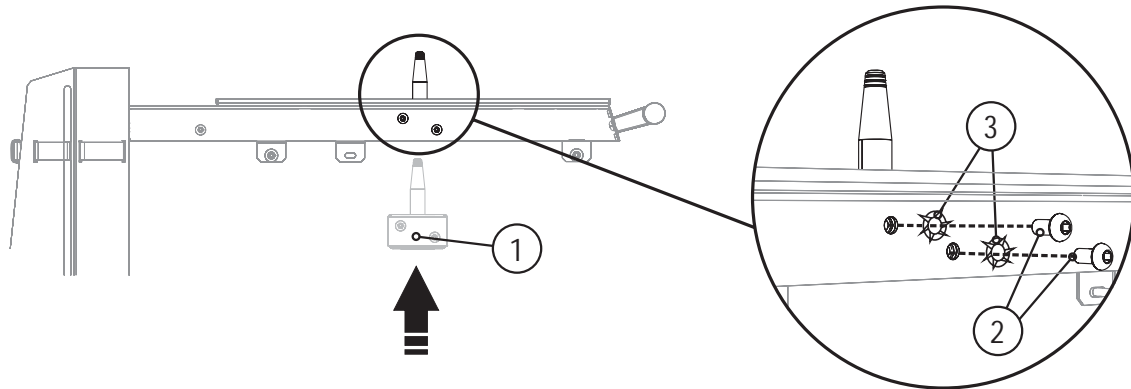

Figure 5-9

Item	Symbol	Description
1		<b>ON PS Trolley 55.2-2 drive 4L</b> Pivot support
2		<b>Oval-head screw</b>
3		<b>Fan-type lock washers</b>

### 5.4.2.1 Setting up the wire feed unit

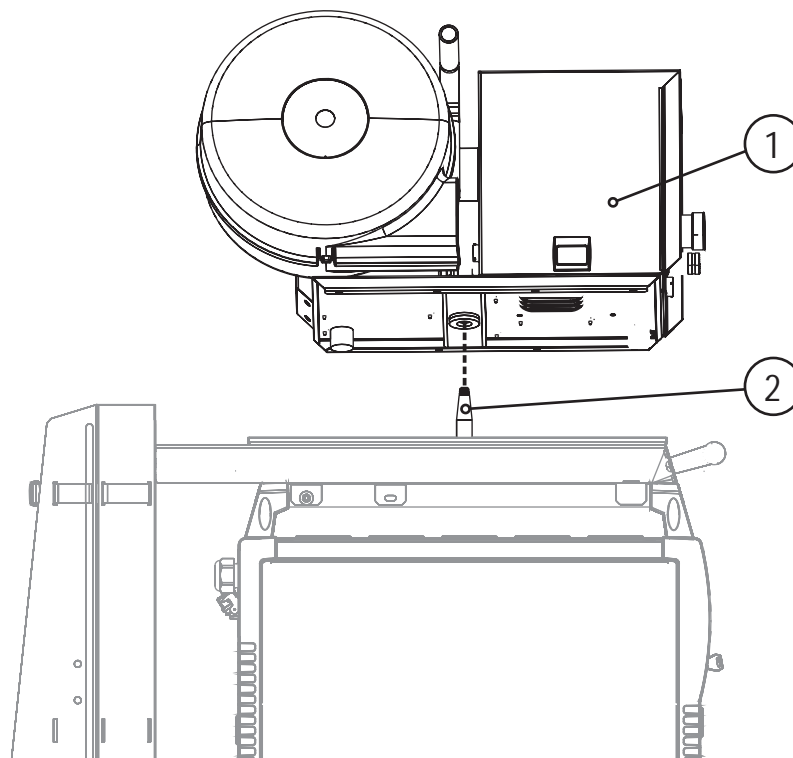

Figure 5-10

Item	Symbol	Description
1		<b>Wire feed unit - drive 4L</b>
2		<b>ON PS Trolley 55.2-2 drive 4L</b> Pivot support

## 5.4.3 ON PS Trolley 55.2-2 drive 200/300C

### CAUTION



#### Improperly secured equipment!

Equipment, equipment combinations and accessories incorrectly fastened onto transport systems can tip over during transport and cause injuries!

- Only used the original parts supplied to fasten the equipment.
- Use the systems only for transporting the machines given in the "Intended use" chapter.
- Check the fixing points before each transport and at regular intervals.

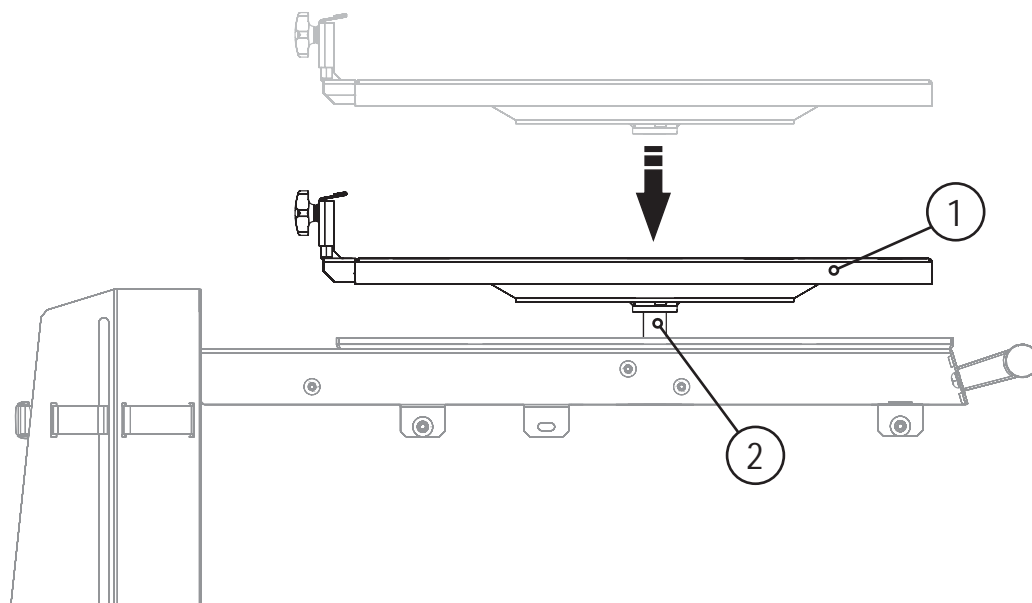

Figure 5-11

Item	Symbol	Description
1		ON PS Trolley 55.2-2 drive 200/300C Pivot support
2		ON PS Trolley 55.2-2 drive 4L Pivot support

## 5.4.3.1 Mount wire feeder on to pivot support

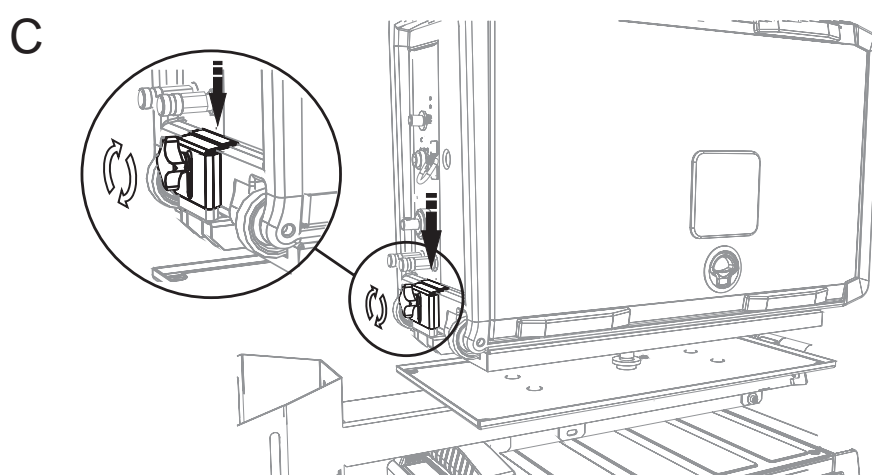
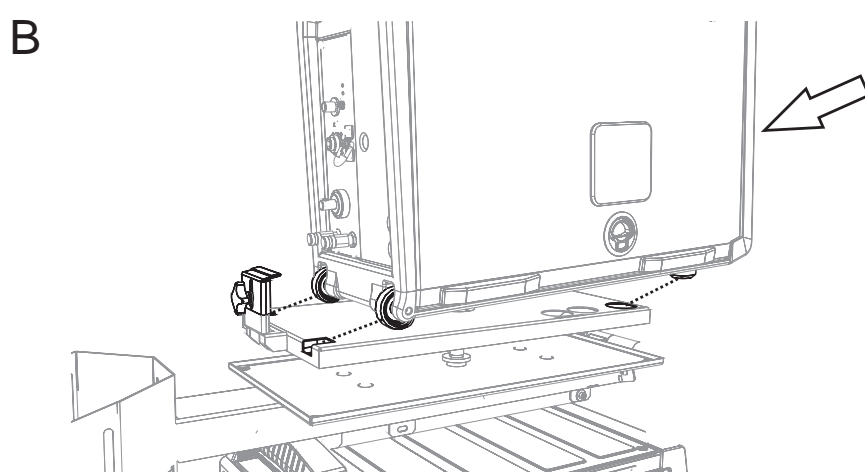
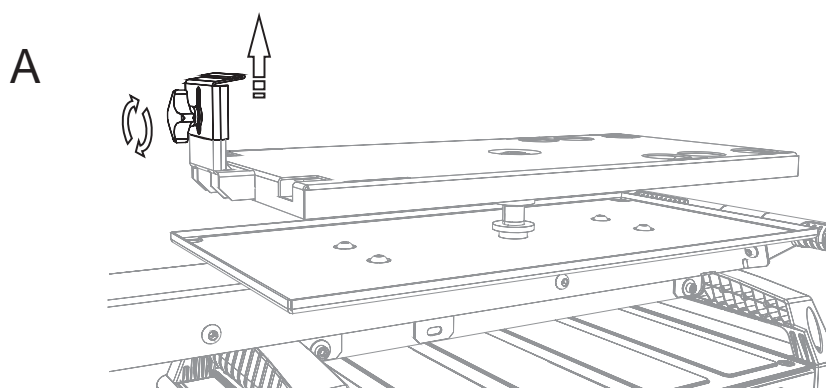

Figure 5-12

## 5.5 Intermediate hose package strain relief

## CAUTION

**Missing or incorrectly fitted strain relief!**

Connection sockets or connection plugs on the machine, or the intermediate tube package, may be damaged if the strain relief is missing or incorrectly fitted. The strain relief takes the strain from cables, plugs and sockets.

- Check the strain relief function by pulling in all directions. Cables and hoses must have sufficient play when the relief cord is fully stretched!

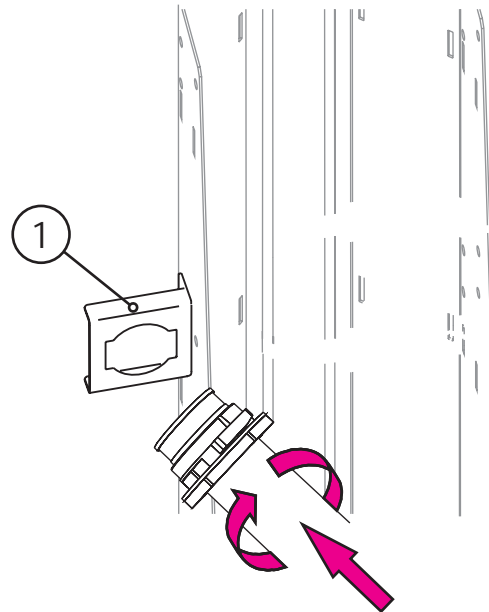

Figure 5-13

Item	Symbol	Description
1		Intermediate hose package strain relief

- Insert the end of the hose package through the strain relief of the hose package and lock by turning to the right.

## 5.6 Final assembly

### **WARNING**



**Danger due to failure to carry out the final inspection!**

**Parts that are incorrectly fitted or that become loose are a source of danger.**

- Check all mechanical connections to ensure that they are fitted correctly!
- Carry out the final inspection!
- Carry out the functional test!

### **CAUTION**



**Risk of accidents due to improperly secured machines!**

**Depending on the machine series the transport vehicle has to be adapted to mount the machine. Failing to adapt the transport vehicle can cause the machine being transported to topple and lead to injuries!**

- Following conversions and prior to each transport make sure all 5 mounting elements are properly tightened!

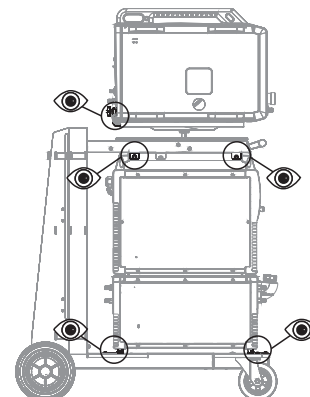



## 5.7 Fixing and securing shielding gas cylinders

### ⚠ WARNING



**Risk of injury due to improper handling of shielding gas cylinders! Improper handling and insufficient securing of shielding gas cylinders can cause serious injuries!**

- Secure shielding gas cylinders using the standard fastening elements on the unit (chain/belt)!
- The fastening elements must tightly enclose the shielding gas cylinder!
- Do not attach any element to the shielding gas cylinder valve!
- Adjust the height of the fastening elements to the shielding gas cylinder size!
- Observe the instructions from the gas manufacturer and any relevant regulations concerning the use of compressed air!
- Avoid heating the shielding gas cylinder!

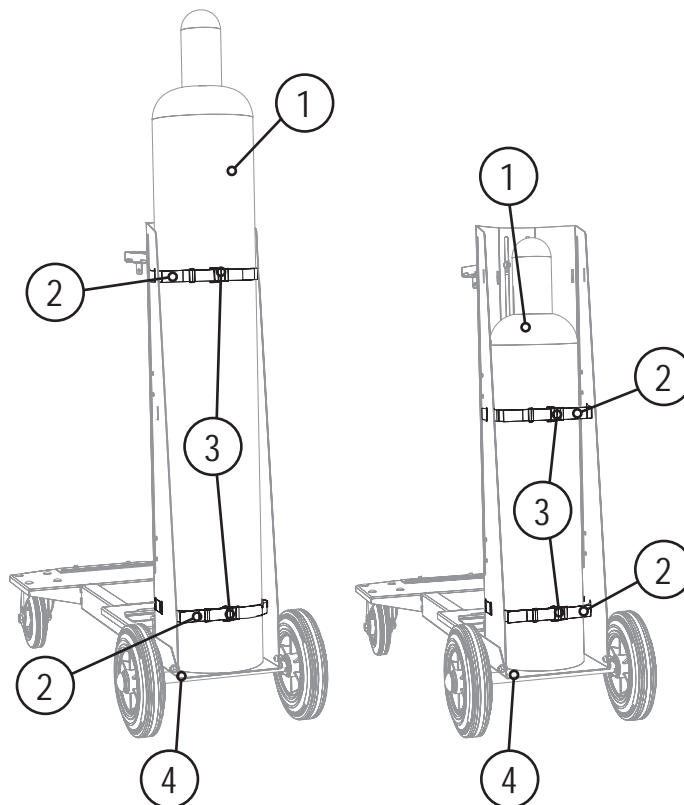
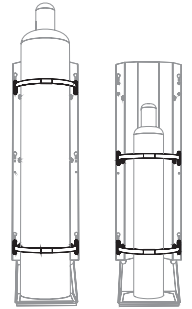

Figure 5-14

Item	Symbol	Description
1		Shielding gas cylinder
2		Straps
3		Tension closure
4		Shielding gas cylinder holder Carrier plate for the shielding gas cylinder

Both large and small shielding gas cylinders can be moved with the transport system.

- Open the tension closures on the straps.
- Place the shielding gas cylinder on the retainer.
- Secure the shielding gas cylinder with the straps.
- Fasten the straps using the tension closures.
- Make sure that the straps fit securely around the gas cylinder.

## 6 Maintenance, care and disposal

### 6.1 General

When used in the specified environmental conditions and under normal operating conditions, this machine is largely maintenance-free and requires a minimum of care.

There are some points which should be observed to guarantee fault-free operation of your welding machine. These include regular cleaning and inspection as described below, depending on the degree of soiling in the surroundings and how long the transport vehicle is in use.

### 6.2 Maintenance work, intervals

#### 6.2.1 Daily maintenance tasks

- Gas cylinder securing elements
- Other, general condition
- Keep moving parts clean.
- Wheels and their securing elements
- Transport elements (strap, lifting lugs, handle)

#### 6.2.2 Monthly maintenance tasks

- Tighten the screw connections.
- Check bearings for damage.
- Service at regular intervals and check for errors.

### 6.3 Maintenance work



#### DANGER



**Do not carry out any unauthorised repairs or modifications!**

**To avoid injury and equipment damage, the unit must only be repaired or modified by specialist, skilled persons!**

**The warranty becomes null and void in the event of unauthorised interference.**

- Appoint only skilled persons for repair work (trained service personnel)!

Repair and maintenance work may only be performed by qualified authorised personnel; otherwise the right to claim under warranty is void. In all service matters, always consult the dealer who supplied the machine. Return deliveries of defective equipment subject to warranty may only be made through your dealer. When replacing parts, use only original spare parts. When ordering spare parts, please quote the machine type, serial number and item number of the machine, as well as the type designation and item number of the spare part.

### 6.4 Disposing of equipment

#### NOTE



**Proper disposal!**

**The machine contains valuable raw materials, which should be recycled, and electronic components, which must be disposed of.**

- Do not dispose of in household waste!
- Observe the local regulations regarding disposal!



## 6.4.1 Manufacturer's declaration to the end user

- According to European provisions (guideline 2002/96/EG of the European Parliament and the Council of January, 27th 2003), used electric and electronic equipment may no longer be placed in unsorted municipal waste. It must be collected separately. The symbol depicting a waste container on wheels indicates that the equipment must be collected separately.  
This machine is to be placed for disposal or recycling in the waste separation systems provided for this purpose.
- According to German law (law governing the distribution, taking back and environmentally correct disposal of electric and electronic equipment (ElektroG) from 16.03.2005), used machines are to be placed in a collection system separate from unsorted municipal waste. The public waste management utilities (communities) have created collection points at which used equipment from private households can be disposed of free of charge.
- Information about giving back used equipment or about collections can be obtained from the respective municipal administration office.
- EWM participates in an approved waste disposal and recycling system and is registered in the Used Electrical Equipment Register (EAR) under number WEEE DE 57686922.
- In addition to this, returns are also possible throughout Europe via EWM sales partners.

## 6.5 Meeting the requirements of RoHS

We, EWM HIGHTEC Welding GmbH Mündersbach, hereby confirm that all products supplied by us which are affected by the RoHS Directive, meet the requirements of the RoHS (Directive 2002/95/EC).

## 7 Technical data

### 7.1 Trolley 55.2-2

<b>Dimensions (LxWxH) in mm</b>	1070 x 530 x 1150
<b>Weight without accessories</b>	Approx. 34 kg
<b>Constructed to standard</b>	IEC 60974-1
<b>gas cylinders</b>	20l/200bar 20l/300bar 50l/200bar

#### 7.1.1 ON TR Trolley 55.2-2

<b>Dimensions (LxWxH) in mm</b>	753 x 374 x 88,5
<b>Weight without accessories</b>	Approx. 6 kg

#### 7.1.2 ON PS Trolley 55.2-2 drive 4L

<b>Dimensions (LxWxH) in mm</b>	83 x 83 x 126
<b>Weight without accessories</b>	Approx. 0,98 kg

#### 7.1.3 ON PS Trolley 55.2-2 drive 200/300C

<b>Dimensions (LxWxH) in mm</b>	572 x 253 x 130,5
<b>Weight without accessories</b>	Approx. 3 kg

## 8 Appendix A

### 8.1 Overview of EWM branches

#### Headquarters

**EWM HIGHTEC WELDING GmbH**  
Dr. Günter-Henle-Straße 8  
56271 Mündersbach · Germany  
Tel: +49 2680 181-0 · Fax: -244  
www.ewm-group.com · info@ewm-group.com

#### Technology centre

**EWM HIGHTEC WELDING GmbH**  
Forststr. 7-13  
56271 Mündersbach · Germany  
Tel: +49 2680 181-0 · Fax: -144  
www.ewm-group.com · info@ewm-group.com



#### Production, Sales and Service

**EWM HIGHTEC WELDING GmbH**  
Dr. Günter-Henle-Straße 8  
56271 Mündersbach · Germany  
Tel: +49 2680 181-0 · Fax: -244  
www.ewm-group.com · info@ewm-group.com

**EWM HIGHTEC WELDING (Kunshan) Ltd.**  
10 Yuanshan Road, Kunshan · New & High-tech Industry Development Zone  
Kunshan · Jiangsu · 215300 · People's Republic of China  
Tel: +86 512 57867-188 · Fax: -182  
www.ewm-kunshan.cn · info@ewm-kunshan.cn

**EWM HIGHTEC WELDING AUTOMATION GmbH**  
Boxbachweg 4  
08606 Oelsnitz/V. · Germany  
Tel: +49 37421 20-300 · Fax: -318  
www.ewm-automation.de · info@ewm-automation.de

**EWM HIGHTEC WELDING s.r.o.**  
Tr. 9. května 718 / 31  
407 53 Jiříkov · Czech Republic  
Tel: +420 412 358-551 · Fax: -504  
www.ewm-jirikov.cz · info@ewm-jirikov.cz

#### Sales and Service Germany

**EWM HIGHTEC WELDING GmbH**  
Vertriebs- und Technologiezentrum  
Grünauer Fenn 4  
14712 Rathenow · Tel: +49 3385 49402-0 · Fax: -20  
www.ewm-rathenow.de · info@ewm-rathenow.de

**EWM HIGHTEC WELDING GmbH**  
Lindenstraße 1a  
38723 Seesen-Rhüden · Tel: +49 5384 90798-0 · Fax: -20  
www.ewm-seesen.de · info@ewm-seesen.de

**EWM HIGHTEC WELDING GmbH**  
Sachsstraße 28  
50259 Pulheim · Tel: +49 2234 697-047 · Fax: -048  
www.ewm-pulheim.de · info@ewm-pulheim.de

**EWM HIGHTEC WELDING GmbH**  
In der Florinskaul 14-16  
56218 Mülheim-Kärlich · Tel: +49 261 988898-0 · Fax: -20  
www.ewm-muelheim-kaerlich.de · info@ewm-muelheim-kaerlich.de

**EWM HIGHTEC WELDING GmbH**  
Eiserfelder Straße 300  
57080 Siegen · Tel: +49 271 3878103-0 · Fax: -9  
www.ewm-siegen.de · info@ewm-siegen.de

**EWM HIGHTEC WELDING GmbH**  
Vertriebs- und Technologiezentrum  
Draisstraße 2a  
69469 Weinheim · Tel: +49 6201 84557-0 · Fax: -20  
www.ewm-weinheim.de · info@ewm-weinheim.de

**EWM Schweißtechnik Handels GmbH**  
Rittergasse 1  
89143 Blaubeuren · Tel: +49 7344 9191-75 · Fax: -77  
www.ewm-blaubeuren.de · info@ewm-blaubeuren.de

**EWM Schweißtechnik Handels GmbH**  
Heinkelstraße 8  
89231 Neu-Ulm · Tel: +49 731 7047939-0 · Fax: -15  
www.ewm-neu-ulm.de · info@ewm-neu-ulm.de

**EWM HIGHTEC WELDING AUTOMATION GmbH**  
Steinfeldstrasse 15  
90425 Nürnberg · Tel: +49 911 3841-727 · Fax: -728  
www.ewm-automation.de · info@ewm-automation.de

#### Sales and Service International

**EWM HIGHTEC WELDING GmbH**  
Fichtenweg 1  
4810 Gmunden · Austria · Tel: +43 7612 778 02-0 · Fax: -20  
www.ewm-gmunden.at · info@ewm-gmunden.at

**EWM HIGHTEC WELDING UK Ltd.**  
Unit 2B Coopies Way · Coopies Lane Industrial Estate  
Morpeth · Northumberland · NE61 6JN · Great Britain  
Tel: +44 1670 505875 · Fax: -514305  
www.ewm-morpeth.co.uk · info@ewm-morpeth.co.uk

**EWM HIGHTEC WELDING (Kunshan) Ltd.**  
10 Yuanshan Road, Kunshan · New & High-tech Industry Development Zone  
Kunshan · Jiangsu · 215300 · People's Republic of China  
Tel: +86 512 57867-188 · Fax: -182  
www.ewm-kunshan.cn · info@ewm-kunshan.cn

**EWM HIGHTEC WELDING Sales s.r.o. / Prodejní a poradenské centrum**  
Tyršova 2106  
256 01 Benešov u Prahy · Czech Republic  
Tel: +420 317 729-517 · Fax: -712  
www.ewm-benesov.cz · info@ewm-benesov.cz

**EWM HIGHTEC WELDING FZCO / Regional Office Middle East**  
LOB 21 G 16 · P.O. Box 262851  
Jebel Ali Free Zone · Dubai, UAE · United Arab Emirates  
Tel: +971 48870-322 · Fax: -323  
www.ewm-dubai.ae · info@ewm-dubai.ae